



Welch Allyn GS 777 Wall Transformer

901093 WALL TRANSFORMER

Instructions for use
ENGLISH

This manual applies to REF 777XXX.

REF 777203, 80031015 A, Revision date: 2025-01

Rx ONLY For use by or on the order of a licensed medical professional

Welch Allyn, Inc.
4341 State Street Road
Skaneateles Falls, NY 13153 USA

baxter.com

Welch Allyn Limited
Navan Business Park, Dublin Road,
Navan, Co. Meath C15 AW22
Ireland

Authorized Australian Sponsor
Welch Allyn Australia Pty Limited
1 Baxter Drive
Old Toongabbie NSW 2146
Australia

CH REP

Hill-Rom S.A.
Chemin du Vallon 26
CH-1030 Bussigny

Intended use

This product is intended to supply power to Welch Allyn 3.5V instruments:
117, 118, 182, 202, 217, 238, 239, 250, 260, 265, 270, 281, 411, and 433 Series.

The **Welch Allyn GS777 Wall Transformer** is intended for use in ambulatory and acute care settings. The device is intended for users that are medically qualified, trained healthcare professionals.

Symbol descriptions

For information on the origin of these symbols, see the Welch Allyn symbols glossary:
welchallyn.com/symbolsglossary.

WARNING The warning statements in this manual identify conditions or practices that could lead to illness, injury, or death. Warning symbols will appear with a grey background in a black and white document.

CAUTION The caution statements in this manual identify conditions or practices that could result in damage to the equipment or other property, or loss of data.

NOTE Presents clarification about an instruction or helpful information about a feature or behavior.

- Product Identifier
- Reorder number
- Lot code
- Global Trade Item Number
- Consult instructions for use
- Medical device
- Authorized Representative in Switzerland

CE Marking of Conformity

Manufacturer

Authorized Representative in the European Community

EU Importer symbol

Separate collection of Electrical and Electronic Equipment. Do not dispose as unsorted municipal waste.

Intertek Testing Laboratories Approved (ETL)

AC input power

- DC input power
- DC output power
- China RoHs. The product does not contain restricted substances.
- Illuminated: Power is present. Not illuminated: No power.
- Type BF applied part

Warnings and cautions

WARNING Read and understand the instructions before using this product. Failure to understand the operating requirements for this product can result in injury to you or the patient and can damage the product.

WARNING Electric shock hazard. Do not simultaneously touch the patient and the center metal contact of the handle.

WARNING Do not modify this equipment. Any modification of this equipment can lead to injury. Any modification of this equipment voids the product warranty.

WARNING Use of accessories, transducers and cables other than those specified or provided by the manufacturer of this equipment could result in increased electromagnetic emissions or decreased electromagnetic immunity of this equipment and result in improper operation.

WARNING Use of this equipment adjacent to or stacked with other equipment should be avoided because it could result in improper operation. If such use is necessary, this equipment and the other equipment should be observed to verify that they are operating normally. Portable RF communications equipment (including peripherals such as antenna cables and external antennas) should be used no closer than 30 cm (12 inches) to any part of the [ME equipment or ME system], including cables specified by the manufacturer. Otherwise, degradation of the performance of this equipment could result.

CAUTION Only authorized Baxter Service Centers can perform service on this product.

CAUTION To make sure that the transformer can be unplugged from the AC power source, never block access to the wall socket.

Residual risk

This product complies with relevant electro-magnetic interference, mechanical safety, performance, and biocompatibility standards. However, the product cannot completely eliminate potential patient or user harm from the following:

- Harm or device damage associated with electro-magnetic hazards,
- Harm from mechanical hazards,
- Harm from device, function, or parameter unavailability,
- Harm from misuse error, such as inadequate cleaning, and/or
- Harm from device exposure to biological triggers that may result in a severe systemic allergic reaction.

Setup

WARNING Baxter is not responsible for the integrity of any mounting installation. Baxter recommends that customers contact their Biomedical Engineering Department or maintenance service to ensure professional installation for safety and reliability of any mounting accessory.

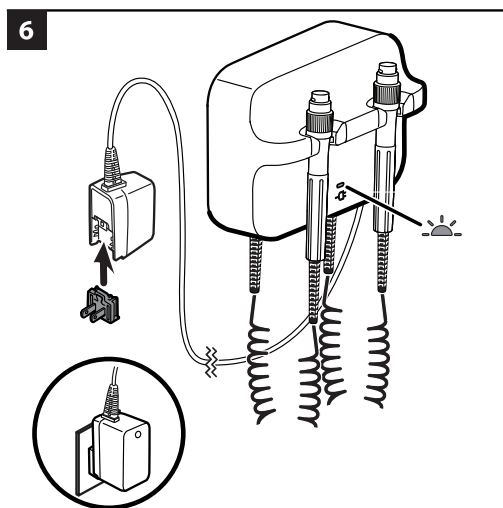
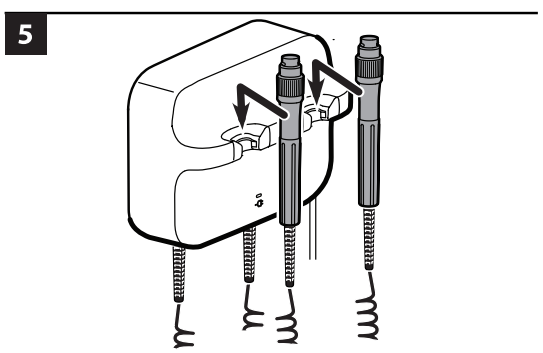
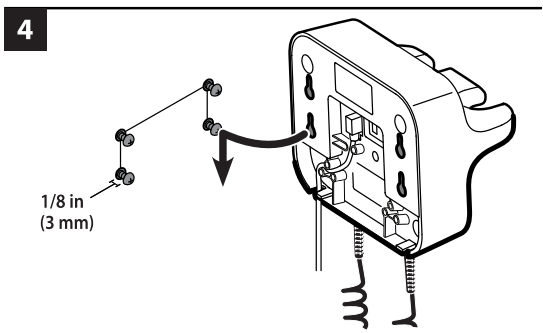
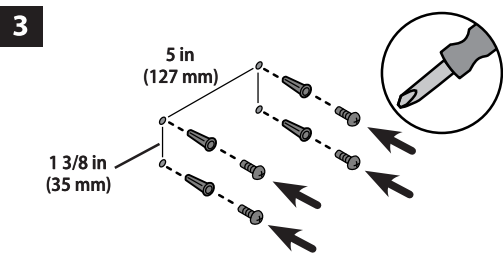
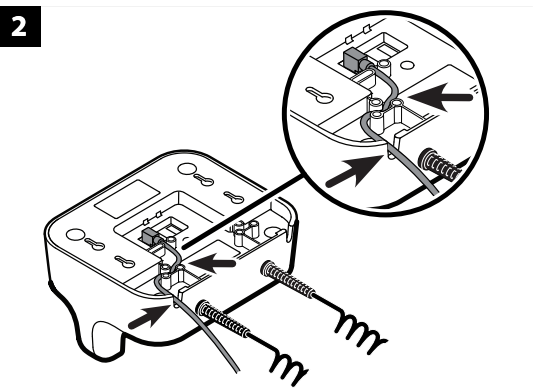
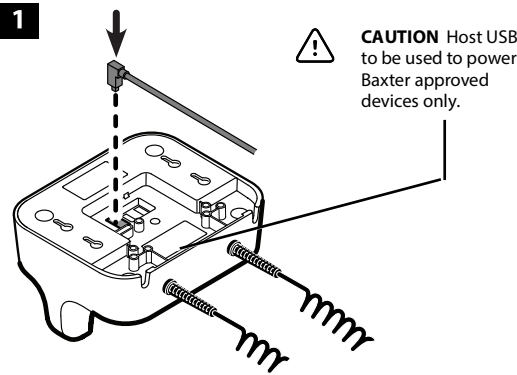
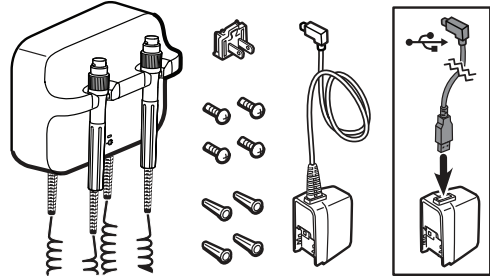

Attach only approved Baxter 3.5V instrument heads of your choice to the handles all others are restricted. See the instructions for use for each instrument head.

Using the handles

Ensure that the transformer is plugged in.

- Lift the handle from the cradle.
The instrument powers on. Only one instrument can be powered at a time.
- Adjust the light output by turning the rheostat on the handle. Turning the rheostat clockwise increases the light output.
Turning the rheostat counterclockwise decreases the light output.

NOTE Decreasing the light output to the minimum level does not power down the instrument.

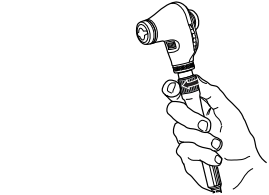

- Follow the instructions for use for the instrument head when examining a patient.

CAUTION To prevent damage, do not overstretch the cords on the handles.

WARNING To minimize the external housing temperature of the instrument head, on-time must not exceed 2 minutes, and off-time must be a minimum of 10 minutes.

NOTES:
Maximum temperature reached by GS777 is 43C.
This device is for professional use only and to discontinue use of the device or take a break if discomfort is felt

- Return the handle to the cradle.
The 3.5V instrument powers down.

Cleaning

WARNING Before you clean the transformer, unplug it from the wall socket.

WARNING Electric shock hazard. DO NOT autoclave the transformer or accessories.

WARNING Liquids can damage electronics inside the wall transformer and power supply. Prevent liquids from spilling on or dripping into the wall transformer and power supply. If liquids are spilled on or drip into the power supply, DO NOT TOUCH the wet power supply. Contact a biomedical engineer or electrician to remove, disassemble, and dry power supply and wall plug adapter. If liquids are spilled on or drip into the wall transformer:

- Disconnect the power plug.
- Remove the transformer from the wall.
- Dry off excess liquid from the wall transformer.
- Mount the transformer on the wall.
- Ensure power supply and wall plug assembly are dry before plugging into outlet.
- Verify transformer functions normally.

Clean the wall transformer on a routine basis according to your facility's protocols and standards or local regulations.

To clean the wall transformer (excluding the instrument heads and power supply), use any of the following:

- A clean cloth slightly dampened with 70 percent isopropyl alcohol or 10 percent chlorine bleach solution. Wipe dry with a clean cloth.
- Sani-Cloth** Plus.
- CaviWipes** (see caution below).

CAUTION Do not use **CaviWipes** to clean the blue handle cradles or the power supply. This cleaning agent produces bubbles and liquid during the cleaning process that can enter openings in the cradles and limit handle performance for as long as 30 minutes after cleaning. To clean the instrument heads, follow their instructions for use.

WARNING Electric shock hazard. If you clean the power supply, take the following precautions:

- Ensure the power supply is unplugged from the outlet.
- Ensure cleaning cloth is not dripping or over-saturated.
- Apply minimal pressure on wipe when cleaning; avoid wiping gap or connection areas on the power supply and wall plug.
- Ensure the power supply, wall plug, and cord are dry before plugging into outlet.

Inspection

Routinely inspect the power cord and accessories for wear, fraying, or other damage. Do not use if you see signs of damage, if the instrument malfunctions, appears not to be working properly, or if you notice a change in performance. Contact Baxter Technical Support for assistance.

Disposal

Users must adhere to all federal, state, regional, and/or local laws and regulations as they pertain to the safe disposal of medical devices and accessories. If in doubt, the user of the device should first contact Baxter Technical Support for guidance on safe disposal protocols. baxter.com/weee-201219eu



Baxter Technical Support

For information about any Baxter product, contact Baxter Technical Support at baxter.com/contact-us

Notice to users and/or patients in EU

Any serious incident that has occurred in relation to the device should be reported to the manufacturer and the competent authority of the Member State in which the user and/or patient is established.

Specifications
Environment

Operating

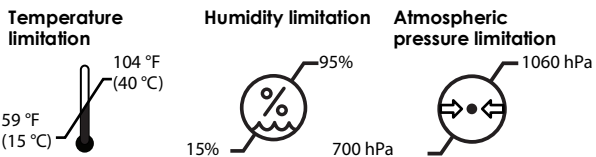

Transport/storage

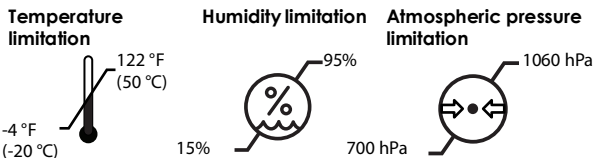

Safety class II, intermittent operation
Electrical power supply

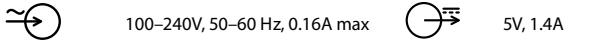

Transformer



Standards and compliance

The device complies with the following standards:
IEC 60601-1
IEC 60601-1-2
Country-specific standards are included in the applicable Declaration of Conformity



Lot code

Lot Decoder: YYDDDT where
YY = Last two digits of the year
DDD = Day of the year
T = Machine

Guidance and manufacturer's declaration

For information about electromagnetic compatibility (EMC), see the Baxter website: welchallyn.com/emc-777.

A printed copy of EMC Emissions and immunity information can be ordered from Baxter for delivery within 7 calendar days.

Accessories list

Part #	Description
408781	777 WALL MOUNTING KIT
408970	Green Series 777 USB Cable, 777 to ProBP 3400 on Integrated Wall System
772289	USB A TO B-RIGHT ANGLE, 8.0FT FOR USE WITH 772221 POWER SUPPLY
772320	USB A TO B-RIGHT ANGLE, 1.5FT FOR USE WITH 772221 POWER SUPPLY
772221	POWER SUPPLY,5V,1.4A,USB-A
775646	POWER SUPPLY,5V,1.4A WITH 72IN (183CM) ATTACHED POWER CORD
728041	AC BLADE FOR 772221 AND 775646 PWR SUPPLY, US
728044	AC BLADE FOR 772221 AND 775646 PWR SUPPLY, UK
728042	AC BLADE FOR 772221 AND 775646 PWR SUPPLY, EU
728043	AC BLADE FOR 772221 AND 775646 PWR SUPPLY, AUS
772224	AC BLADE FOR 772221 AND 775646 PWR SUPPLY, CHINA
772225	AC BLADE FOR 772221 AND 775646 PWR SUPPLY, SOUTH AFRICA
772222	AC BLADE FOR 772221 AND 775646 PWR SUPPLY, BRAZIL
PWCD-GS777-B	USB POWER SUPPLY & CORD KIT, US
PWCD-GS777-4	USB POWER SUPPLY & CORD KIT, UK
PWCD-GS777-2	USB POWER SUPPLY & CORD KIT, EU
PWCD-GS777-6	USB POWER SUPPLY & CORD KIT, AUS
PWCD-GS777-C	USB POWER SUPPLY & CORD KIT, CHINA
PWCD-GS777-7	USB POWER SUPPLY & CORD KIT, SOUTH AFRICA
PWCD-GS777-Z	USB POWER SUPPLY & CORD KIT, BRAZIL
7670-12	767 WALL SYSTEMS ROLLING MOBILE STAND

Applied part	Head, Handle
--------------	--------------

Warranty

Five-year limited warranty.