



# Welch Allyn® GS 777 Wall Transformer

REF 777XX # 901093 WALL TRANSFORMER

## Instructions for use

REF 773704, DIR 80028385 Ver. A, Revision date: 2021-04

**R<sub>x</sub> ONLY** For use by or on the order of a licensed medical professional

© 2021 Welch Allyn, Inc. All rights reserved. No one is permitted to reproduce or duplicate, in any form, this instructions for use or any part thereof without permission from Welch Allyn. Welch Allyn, Inc. ("Welch Allyn") assumes no responsibility for any injury to anyone that may result from (i) failure to properly use the product in accordance with the instructions, cautions, warnings, or statement of intended use published in this manual, or (ii) any illegal or improper use of the product. Welch Allyn is a trademark of Welch Allyn, Inc. Hillrom is a trademark of Hill-Rom Services, Inc.

Welch Allyn, Inc.  
4341 State Street Road  
Skaneateles Falls, NY 13153 USA

hillrom.com  
Welch Allyn, Inc. is a subsidiary of Hill-Rom Holdings, Inc.

and EU IMPORTER  
Welch Allyn Limited  
Navan Business Park, Dublin Road,  
Navan, Co. Meath C15 AW22  
Ireland



Authorized Australian Sponsor  
Welch Allyn Australia Pty. Ltd.  
Unit 4.01, 2-4 Lyonpark Road  
Macquarie Park, NSW 2113  
Phone 1800 650 083

## Intended use

This product is intended to supply power to Welch Allyn 3.5V instruments.

The GS777 Wall Transformer is intended for use in ambulatory and acute care settings. The device is intended for users that are medically qualified, trained healthcare professionals.

## Symbol descriptions

For information on the origin of these symbols, see the Welch Allyn symbols glossary: [welchallyn.com/symbolsglossary](http://welchallyn.com/symbolsglossary)

**WARNING** The warning statements in this manual identify conditions or practices that could lead to illness, injury, or death. Warning symbols will appear with a grey background in a black and white document.

**CAUTION** The caution statements in this manual identify conditions or practices that could result in damage to the equipment or other property, or loss of data.

**NOTE** Presents clarification about an instruction or helpful information about a feature or behavior

- # Product Identifier
- REF Reorder number
- LOT Lot code
- GTIN Global Trade Item Number
- Consult instructions for use
- MD Medical device
- Manufacturer

Authorized Representative in the European Community

Separate collection of Electrical and Electronic Equipment. Do not dispose as unsorted municipal waste.

- AC input power
- DC input power
- DC output power
- China RoHs. The product does not contain restricted substances.
- Illuminated: Power is present. Not illuminated: No power.
- Type BF applied part

## Warnings and cautions

**WARNING** Read and understand the instructions before using this product. Failure to understand the operating requirements for this product can result in injury to you or the patient and can damage the product.

**WARNING** Electric shock hazard. Do not simultaneously touch the patient and the center metal contact of the handle.

**WARNING** Do not modify this equipment. Any modification of this equipment can lead to injury. Any modification of this equipment voids the product warranty.

**WARNING** Use Welch Allyn approved accessories only. Using unapproved accessories can affect the safety and performance, e.g. EMC emissions and immunity, of the device.

**CAUTION** Avoid using this product in close proximity to other equipment. The product complies with current required standards for electromagnetic interference and should not present problems to other equipment or be affected by other devices.

**CAUTION** Only authorized Welch Allyn Service Centers can perform service on this product.

**CAUTION** To make sure that the transformer can be unplugged from the AC power source, never block access to the wall socket.

## Residual risk

This product complies with relevant electro-magnetic interference, mechanical safety, performance, and biocompatibility standards. However, the product cannot completely eliminate potential patient or user harm from the following:

- Harm or device damage associated with electro-magnetic hazards,
- Harm from mechanical hazards,
- Harm from device, function, or parameter unavailability,
- Harm from misuse error, such as inadequate cleaning, and/or
- Harm from device exposure to biological triggers that may result in a severe systemic allergic reaction.

## Setup

**WARNING** Welch Allyn is not responsible for the integrity of any mounting installation. Welch Allyn recommends that customers contact their Biomedical Engineering Department or maintenance service to ensure professional installation for safety and reliability of any mounting accessory.

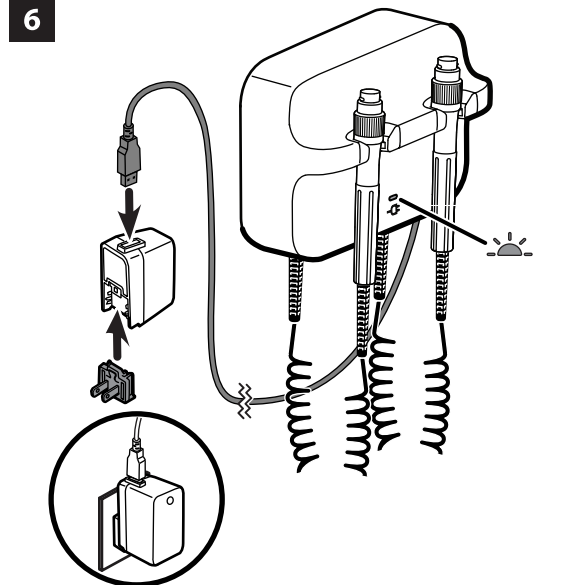
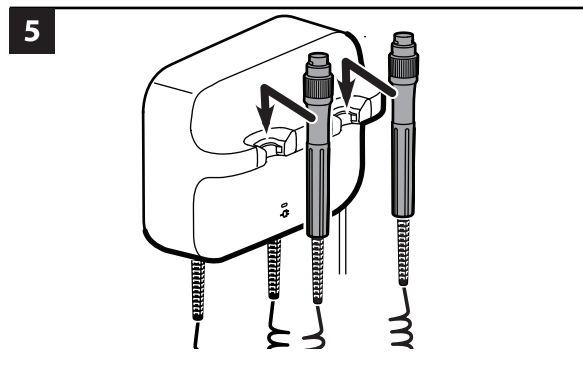
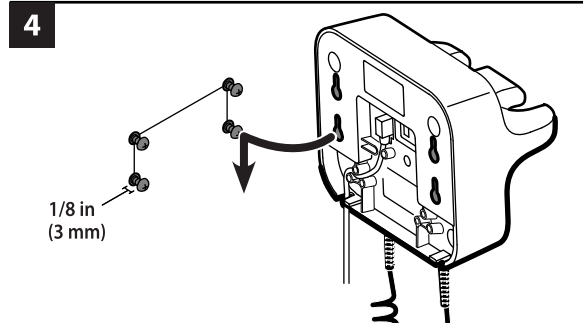
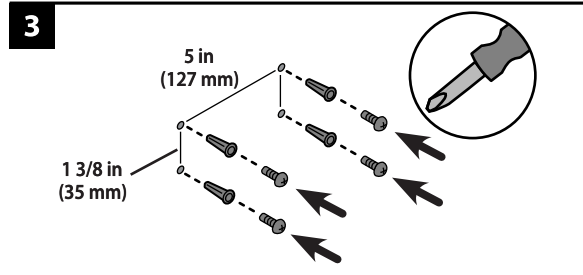
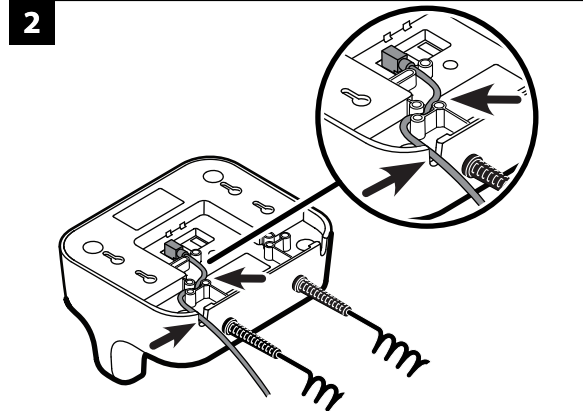
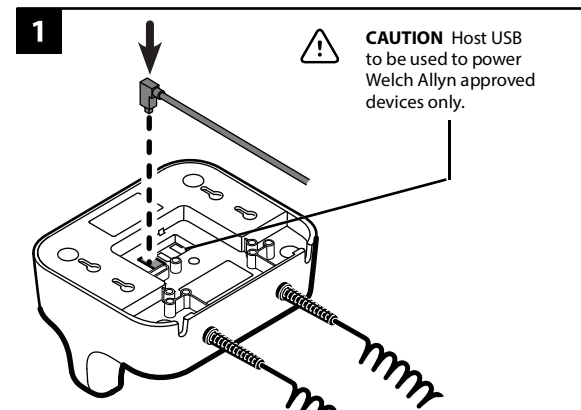
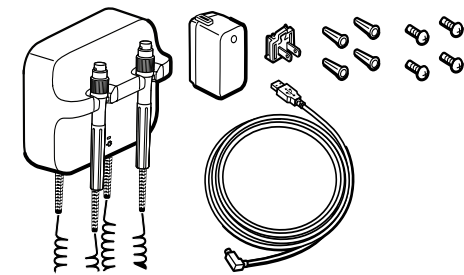

Attach only approved Welch Allyn 3.5V instrument heads of your choice to the handles all others are restricted. See the instructions for use for each instrument head.

## Using the handles

Ensure that the transformer is plugged in.

1. Lift the handle from the cradle.  
The instrument powers on. Only one instrument can be powered at a time.
2. Adjust the light output by turning the rheostat on the handle. Turning the rheostat clockwise increases the light output. Turning the rheostat counterclockwise decreases the light output.

**NOTE** Decreasing the light output to the minimum level does not power down the instrument.

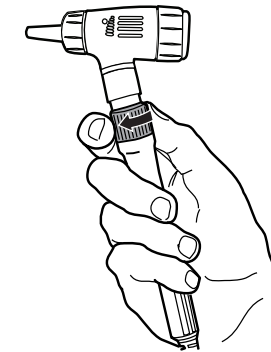

3. Follow the instructions for use for the instrument head when examining a patient.  
**CAUTION** To prevent damage, do not overstretch the cords on the handles.  
**CAUTION** To minimize the external housing temperature of the instrument head, on-time must not exceed 2 minutes, and off-time must be a minimum of 10 minutes.
4. Return the handle to the cradle.  
The 3.5V instrument powers down.

## Cleaning

- WARNING** Before you clean the transformer, unplug it from the wall socket.
- WARNING** Electric shock hazard. DO NOT autoclave the transformer or accessories.
- WARNING** Liquids can damage electronics inside the wall transformer and power supply. Prevent liquids from spilling on or dripping into the wall transformer and power supply. If liquids are spilled on or drip into the power supply, DO NOT TOUCH the wet power supply. Contact a biomedical engineer or electrician to remove, disassemble, and dry power supply and wall plug adapter. If liquids are spilled on or drip into the wall transformer:
  1. Disconnect the power plug.
  2. Remove the transformer from the wall.
  3. Dry off excess liquid from the wall transformer.
  4. Mount the transformer on the wall.
  5. Ensure power supply and wall plug assembly are dry before plugging into outlet.
  6. Verify transformer functions normally.

Clean the wall transformer on a routine basis according to your facility's protocols and standards or local regulations.

To clean the wall transformer (excluding the instrument heads and power supply), use any of the following:

- A clean cloth slightly dampened with 70 percent isopropyl alcohol or 10 percent chlorine bleach solution. Wipe dry with a clean cloth.
- Sani-Cloth<sup>®</sup> Plus.
- CaviWipes<sup>™</sup> (see caution below).

**CAUTION** Do not use CaviWipes to clean the blue handle cradles or the power supply. This cleaning agent produces bubbles and liquid during the cleaning process that can enter openings in the cradles and limit handle performance for as long as 30 minutes after cleaning. To clean the instrument heads, follow their instructions for use.

**WARNING** Electric shock hazard. If you clean the power supply take the following precautions:

- Ensure the power supply is unplugged from the outlet.
- Ensure cleaning cloth is not dripping or over-saturated.
- Apply minimal pressure on wipe when cleaning; avoid wiping gap or connection areas on the power supply and wall plug.
- Ensure the power supply, wall plug, and cord are dry before plugging into outlet.

## Inspection

Routinely inspect the power cord and accessories for wear, fraying, or other damage. Do not use if you see signs of damage, if the instrument malfunctions, appears not to be working properly, or if you notice a change in performance. Contact Hillrom's Technical Support for assistance.

## Disposal

Users must adhere to all federal, state, regional, and/or local laws and regulations as they pertain to the safe disposal of medical devices and accessories. If in doubt, the user of the device should first contact Hillrom Technical Support for guidance on safe disposal protocols.

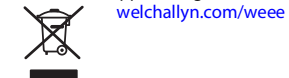

## PATENT/PATENTS

hillrom.com/patents  
May be covered by one or more patents. See above Internet address. The Hill-Rom companies are the proprietors of European, US, and other patents and pending patent applications.

## Hillrom Technical Support

For information about any Hillrom product, contact Hillrom Technical Support at [hillrom.com/en-us/about-us/locations](http://hillrom.com/en-us/about-us/locations)

## Notice to users and/or patients in EU

Any serious incident that has occurred in relation to the device should be reported to the manufacturer and the competent authority of the Member State in which the user and/or patient is established.

## Specifications Environment

### Operating

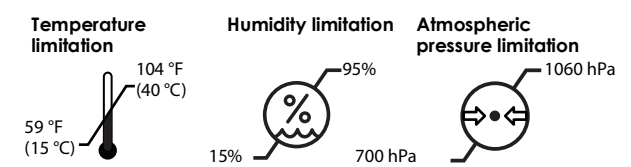

### Transport/storage

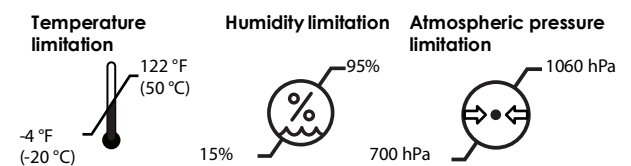

## Safety class II, intermittent operation Electrical power supply

	100-240V, 50-60 Hz, 0.16A max		5V, 1.4A
	5V, 1A		5V, 0.5A

## Standards and compliance

The device complies with the following standards:  
IEC 60601-1  
IEC 60601-1-2  
Country-specific standards are included in the applicable Declaration of Conformity



## Lot code

Lot Decoder: YYDDDT where  
YY = Last two digits of the year  
DDD = Day of the year  
T = Machine

## Guidance and manufacturer's declaration

For information about electromagnetic compatibility (EMC), see the Welch Allyn website: [welchallyn.com/emc-777](http://welchallyn.com/emc-777).  
A printed copy of EMC Emissions and immunity information can be ordered from Welch Allyn for delivery within 7 calendar days.

## Accessories List

Part #	Description
408781	777 WALL MOUNTING KIT
408970	Green Series 777 USB Cable, 777 to ProBP 3400 on Integrated Wall System
772289	USB A TO B-RIGHT ANGLE, 8.0FT
772320	USB A TO B-RIGHT ANGLE, 1.5FT
772221	POWER SUPPLY, 5V, 1.4A, USB-A
728041	AC BLADE FRIWO PWR SUPPLY, US
728044	AC BLADE FRIWO PWR SUPPLY, UK
728042	AC BLADE FRIWO PWR SUPPLY, EU
728043	AC BLADE FRIWO PWR SUPPLY, AUS
772224	AC BLADE FRIWO PWR SUPPLY, CHINA
772225	AC BLADE FRIWO PWR SUPPLY, SOUTH AFRICA
772222	AC BLADE FRIWO PWR SUPPLY, BRAZIL

## Warranty

Five-year limited warranty.