

## Remove the communications door

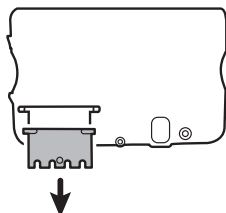

**Note** If the communications door is missing or already removed from the device, proceed to **Replace the communications door** instructions. →



**WARNING** Personal injury risk. Because removing the door might propel the pin and spring into the air, wear safety glasses to complete these steps.

**Before removing the communications door, power down the monitor, remove the battery, and remove the rear housing as described in the service manual.**

1

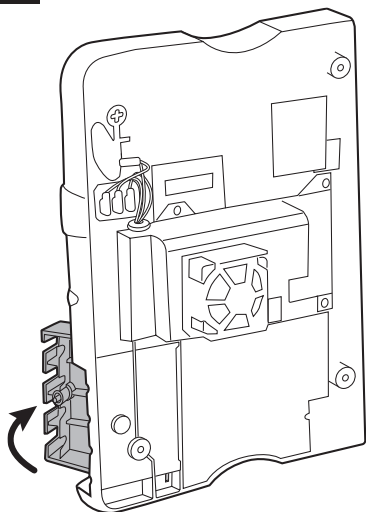

- 1.1 Position the rear housing with the Ethernet connection side down on the antistatic mat
- 1.2 Open the communications door perpendicular to the rear housing.

2

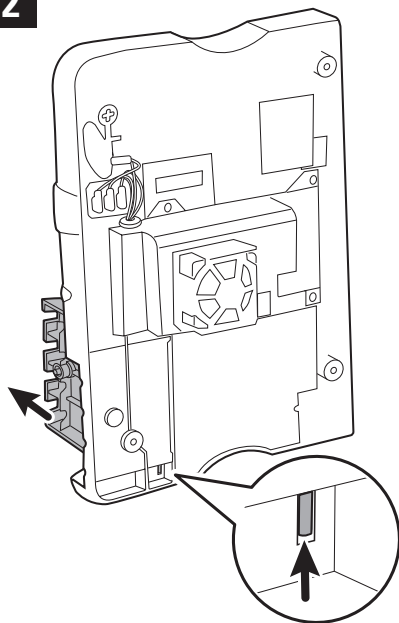

- 2.1 Use a spudger to push the pin upward until the pin clears the plastic hinge.
- 2.2 Carefully remove the door from the rear housing.



# Replace the communications door

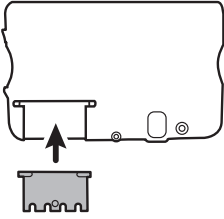

**WARNING** Personal injury risk. Because attaching the door might propel the pin and spring into the air, wear safety glasses to complete this step.

**1**

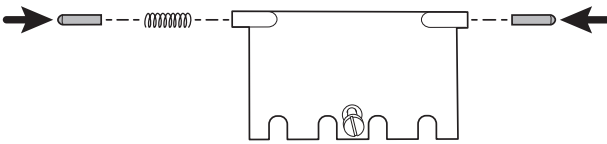

Insert a spring and two pins into the communications door as shown.

**2**

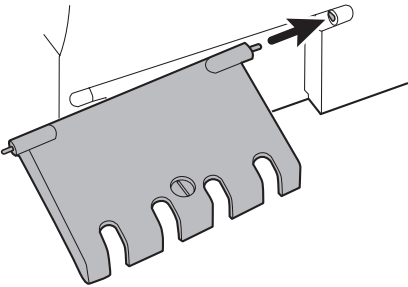

With the bottom of the housing on the antistatic mat, insert the pin on the right side of the door into the hinge of the rear housing.

**3**

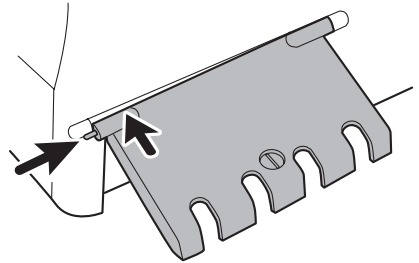

Press the pin into the left side of the door and slide the door into the hinge of the rear housing until it snaps into place.