



**Hillrom™**



## **Horizontal Lifting Solutions**

FlexoStretch™ Lift Stretcher

OctoStretch™ Lift Stretcher

UltraStretch™ Lift Stretcher

LikoStretch 600 IC™ Lift Stretcher

# LIFTING WITH POWER— AND WITH CARE

In the hospital, it takes a special combination of power and gentleness to move patients in a horizontal position — especially when those patients are severely injured. At Hillrom, we've worked with intensive-care specialists around the world to develop horizontal lifting accessories that help you move each patient with care. From the OR to the ICU, and from the Emergency Department to Medical Imaging, we deliver the support you need to keep your patients safe along their path to recovery.

## FlexoStretch™ Lift Stretcher

### FULL FLEXIBILITY FOR BARIATRIC PATIENTS

The FlexoStretch accessory is designed to lift and transfer your patients of size. You can easily adjust its width from 70 - 90 cm / 27.6 - 35.4", and choose between tall or regular XL LiftSheet sizes.

- May be used with our LikoGuard®, Likorall®, Multirall™, Viking® L and XL, and Golvo® lifts
- Safe working load: 300 kg / 660 lbs



## OctoStretch™ Lift Stretcher with Stretch Leveller

### MAXIMIZING HORIZONTAL LIFTING SPACE

From surgical to radiology to ICU departments, the OctoStretch lift accessory can be used with any Hillrom overhead lift, and some mobile lifts as well. Choose the right LiftSheet™ size to get the access you need to care for your patients.

- At just 7.2 kg / 15.9 lbs, this lightweight lift stretcher is easy to operate
- Safe working load: 200 kg / 440 lbs



## UltraStretch™ Lift Stretcher

### FOR YOUR HEAVIEST LIFTS

The UltraStretch accessory is our strongest horizontal lift. It is used with the overhead UltraTwin™ system, which consists of two interconnected LikoTwin™ motors.

- Two fixture points must always be used
- Safe working load: 400 kg / 880 lbs

## LikoStretch Mod 600 IC™ Lift Stretcher

### FOR MORE DEMANDING SITUATIONS

This lift stretcher accessory is designed for patients who need especially careful handling. You can gently apply its weight-bearing lift straps using the Spatula Mod 600 IC (applicator tool)—no need to lift or roll the patient.

- Ideal for ICU for patients who cannot be turned on their sides due to severe burns or fractures in the neck or back.
- Safe working load: 250 kg / 550 lbs





## Find the right support for your patients — and your caregivers — with the right accessories.

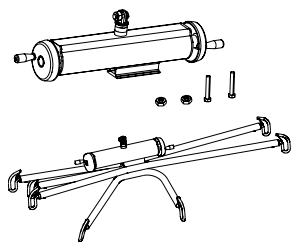

Adjust the center of gravity during patient lifting with the optional Stretch Leveller™, depending on model.

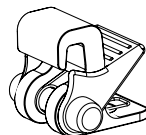

Easily transfer patients between lift systems with the optional quick-release hook system, depending on model.

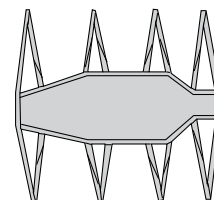

Choose between LiftStraps or LiftSheet™, depending on the model, choose between washable or single-patient use soft accessories.

	OctoStretch™ Accessory	LikoStretch Mod 600 IC™ Accessory	FlexoStretch™ Accessory	UltraStretch™ Accessory
Maximum Weight Capacity	200 kg / 440 lb	250 kg / 550 lb	300 kg / 660 lb	400 kg / 880 lb
Dimensions (L x W x H)	1263 mm x 617 mm x 227 mm / 50" x 24" x 9"	660 mm x 840 mm x 460 mm / 26" x 33" x 18"	1440 mm x 446 mm x 240 mm / 57" x 17" x 9"	1440 mm x 687-927 mm x 176 mm / 57" x 27-36" x 7"
Product Number	3156056 with stretch leveller	3156065B Excl. accessories	3156057 with stretch leveller	3156058
Accessories	3683105 Octo LiftSheet™, M 3683106 Octo LiftSheet, L 3683905-4 Solo Octo LiftSheet, M 3683906-4 Solo Octo LiftSheet, L 3156502 Quick-release hook TDM	3166506 SideRails 600 IC (pair) 3684001 LiftStraps Mod 600 IC, 8 pcs/set 3684002 Spatula Mod 600 IC 3156200 Stretch Leveller 3156502 Quick-release hook TDM	3684105 LiftSheet™ XL, Regular 3684106 LiftSheet XL, Tall 3156508 Quick-release hook universal	3684105 LiftSheet™ XL, Regular 3684106 LiftSheet XL, Tall
Product Compatibility*	LikoGuard® L and XL, Likorall® 200, 242, 243, 250, Multirall™, Viking® M, L, XL, and Golvo® 9000	LikoGuard® L and XL, Likorall® 200, 242, 243, 250, Multirall™, Viking® L, XL, and Golvo® 9000	LikoGuard® L and XL, Likorall® 200, 242, 243, 250, Multirall™, Viking® L, XL, and Golvo® 9000	UltraTwin™ Overhead Lift System

\* Please confirm safe working load for both the lift and horizontal accessory prior to use.

For more information, please contact your Hillrom sales representative at 1-800-445-3730.

[hillrom.com](http://hillrom.com)

Horizontal Accessories are intended for lifting and transferring patients in a horizontal supine position. UltraStretch accessory is designed for heavy patients and LikoStretch Mod 600 IC is intended for extra demanding lifting situations.  
Class I  
Manufacturer: Liko AB, Nedre vägen 100, 975 92 Luleå, Sweden

These products are regulated health care products which, where required by applicable regulations, bear a CE mark. Hill-Rom recommends you carefully read the detailed instructions for safe and proper use included in the documentation accompanying medical devices. The personnel of healthcare establishments are responsible for the proper use and maintenance of these medical devices.

Hill-Rom reserves the right to make changes without notice in design, specifications and models. The only warranty Hill-Rom makes is the express written warranty extended on the sale or rental of its products.