

**Subject: First Impression® Headwall System (P783D)—Installation  
Instructions**

---

**Introduction**

This procedure provides instructions for installing the First Impression®<sup>1</sup> Headwall System (P783D). Before starting this procedure, read and understand all of the instructions for the parts being installed. For the correct room elevation and information about the specific First Impression® Headwall System, refer to the as-built drawings.

Tools required:	As-built drawings	Chalk line
	Level	Tape measure
	Electric drill	1" drill bit
	Safety glasses	Broom
	Dustpan	Heat shield blanket
	Stud finder	Screwdriver

Parts required:	(1)	P783D	First Impression® Headwall System
	(1)	P781D	Hanger assembly, deep/baby, First Impression® Headwall System
	(1)	55934	Bag assembly

P781D, Hanger assembly, deep/baby, First Impression® Headwall System, includes the following items:

(1)	204743	Bag assembly, deep/baby, First Impression® Headwall System
(1)	53910	Hanger—primed

55934, Bag assembly, includes the following items:

(2)	16114	Screw (#6-32 x ½", flat head)
(1)	21352	Snap bushing
(2)	29591	Screw, #8, self-drilling
(1)	55526	Face ring—wall box

204743, Bag assembly, deep/baby, First Impression® Headwall System, includes the following items:

(2)	21045	Toggle bolt
(2)	20146	Toggle wing
(8)	53143-01	Screw, #12, self-drilling, hex head
(2)	29325	Stud guide

---

1. First Impression® is a registered trademark of Hill-Rom Services, Inc.

## Preparing the Wall for Installation



### WARNING:

The installation method differs for each wall and construction type. Failure to determine the wall and construction type could result in the collapse of the First Impression® Headwall System. Personal injury or equipment damage could occur.

1. Before proceeding, refer to the local or state building codes, and determine the wall type and construction type:
  - **Seismic** walls are constructed to prevent damage from an earthquake.
  - **Non-seismic** walls are **not** constructed to prevent damage from an earthquake.
  - **Fire-rated** walls are constructed to prevent the spread of fire.
  - **Non-fire-rated** walls are **not** constructed to prevent the spread of fire.
2. Perform **one** of the following:
  - On **non-seismic** walls, contact Hill-Rom Technical Support at 800-445-3720.
  - For **seismic** walls (both **fire-rated** and **non-fire-rated**), install wall backing plates according to the Office of Statewide Health, Planning, and Development (OSHPD)-approved drawings and the as-built drawings.

### NOTE:

The backing plate, provided by others, must be 6" (15 cm) wide, 14-gauge steel, continuous between steel studs, provided by others, at a maximum of 16" (41 cm) centers.

## Installing the Hanger Assembly (P781D)

1. Refer to the as-built drawings, and determine where the centerline (A) will be after installation, and strike a vertical plumb line on the wall at the centerline (A) (see figure 1 on page 3).
2. Measure 14½" (36.83 cm) to one side of the centerline (A), and make a mark at the location to indicate the edge of the hanger (B).
3. Measure 71 1/8" (180.66 cm) up from the finished floor line (C), and strike a level horizontal line (D) at the location to indicate the top of the hanger (B).
4. Set the hanger (B) on the wall:
  - Put the edge of the hanger (B) at the mark made in step 2.
  - Put the top of the hanger (B) along the level horizontal line (D).

**Figure 1. Hanger Assembly Dimensions**

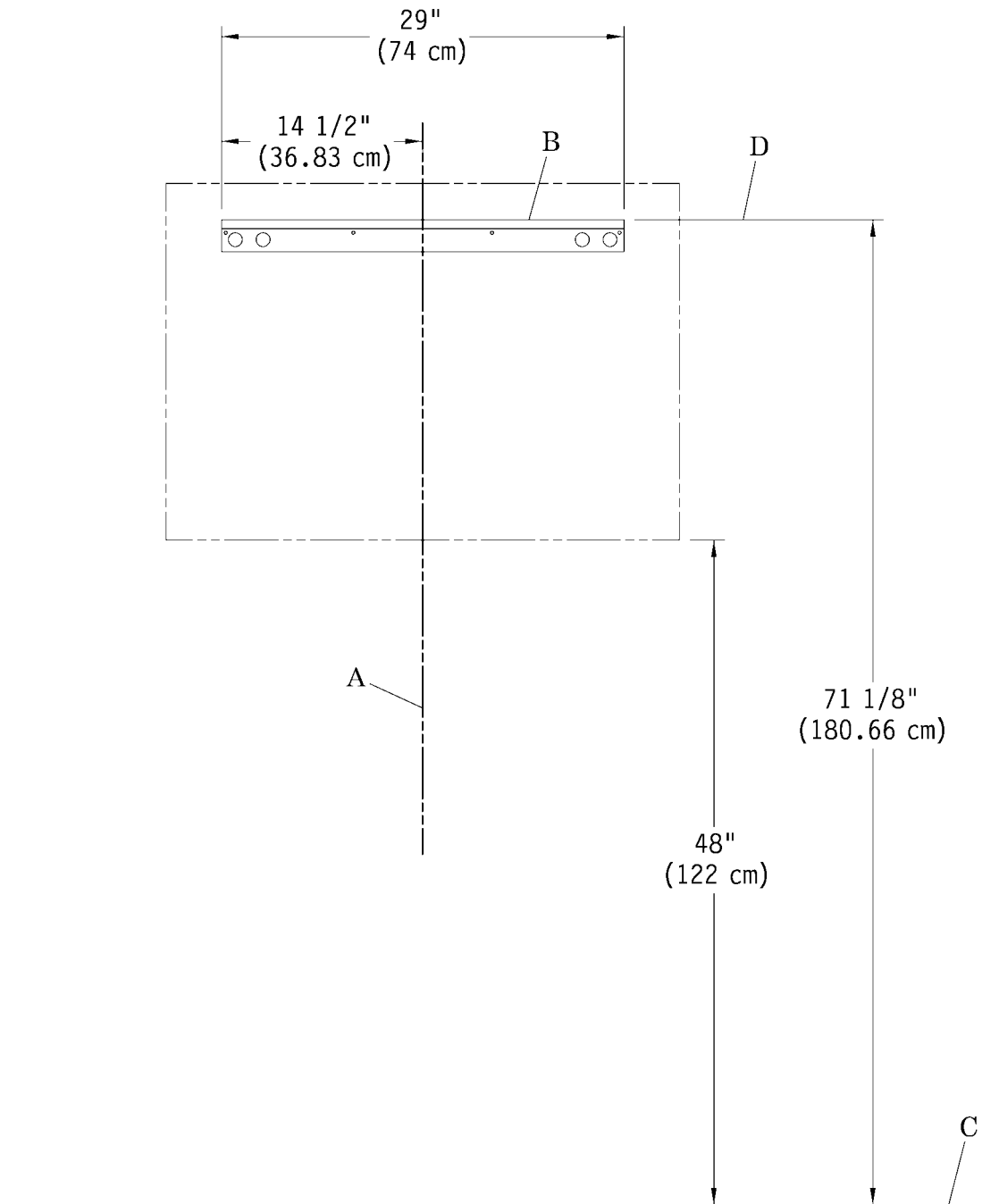

i803\_001

5. On **non-fire-rated** and **non-seismic** walls, do the following:
- Make a mark for the location of the 1" (3 cm) diameter holes (E) of the hanger (B) on the wall (see figure 2 on page 4).

**Figure 2. Hanger Assembly Installation**

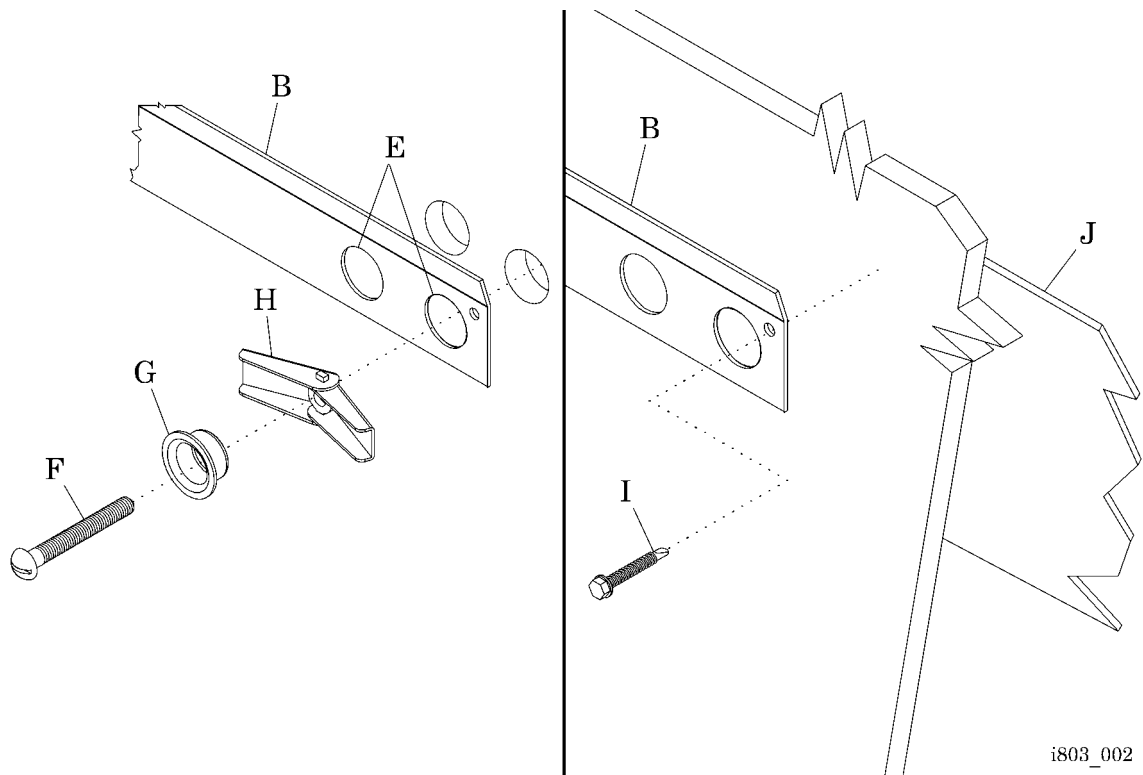

- Remove the hanger (B) from the wall.



**WARNING:**

Wear eye protection. Failure to do so could result in eye injury.

- Put on safety glasses.
  - At the marks made in step a, drill holes through the outermost holes (E) at a location free from obstruction.
  - Clean up any wall debris.
  - Install the two toggle bolts (F), stud guides (G), and toggle wings (H) to secure the hanger (B) to the wall.
6. On **fire-rated** and **seismic** wall, install the eight self-drilling screws (I) to secure the hanger (B) to the backing plate (J). Refer to OSHPD pre-anchorage approval.

## Installing the First Impression® Headwall System (P783D)

1. Install the snap bushing (K) to the face ring (L) (see figure 3 on page 6).
2. Route the wires from the wall box (M) (provided by others) through the snap bushing (K).
3. Install the #6-32 flat head screws (N) provided to secure the face ring (L) to the wall box (M).
4. Remove the correct knockout (O) from the back of the headwall assembly (P) (see figure 3 on page 6) for the **High Voltage** outlet boxes (Q) and **Low Voltage** outlet boxes (R) in the wall (see figure 4 on page 7). For the specific location of the outlet boxes (Q) and (R), refer to the as-built drawings.
5. Remove the faceplate and electrical devices from the outlet boxes (Q) and (R) to permit connecting directly to the electrical devices.
6. Mount the headwall assembly (P) on the hanger (B), and make sure it is set correctly (see figure 3 on page 6).
7. To access the medical rough-in area (S), do the following (see figure 4 on page 7):
  - a. Remove the four screws that secure the top panel (T) to the headwall assembly (P) (see figure 3 on page 6).
  - b. Remove the top panel (T) from the headwall assembly (P).
8. Lift up on the tambour side panels (U) and front corner trim (V), and slide them forward and off the headwall assembly (P).
9. Close the tambour doors (W), and install two self-drilling screws (X) to secure the top of the headwall assembly (P) to the hanger (B).
10. Install two self-drilling screws (Y) to secure the bottom of the headwall assembly (P) to the backing plate (J) or wall studs.
11. Open the tambour doors (W), and install the self-drilling screws (Z) provided through the back of the headwall assembly (P) to secure it to the flange of the face ring (L).



**CAUTION:**

Protect the headwall assembly, electrical raceways, electrical components, and wall from the heat from the brazing torch. Failure to do so could result in equipment damage.

12. To protect the adjacent electrical raceways, electrical components, and wall from excessive heat from the brazing torch, use a heat shield blanket.
13. To prevent the conduction of heat to the interior of the headwall assembly (P), wrap a wet sponge or cloth around the copper tubing beyond the joint.

**Figure 3. First Impression® Headwall System (P783D)**

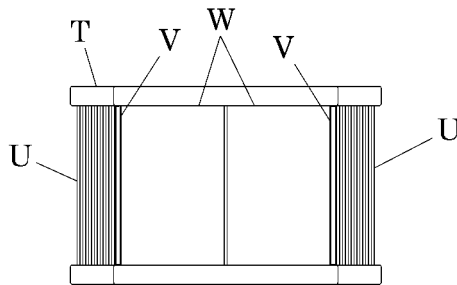
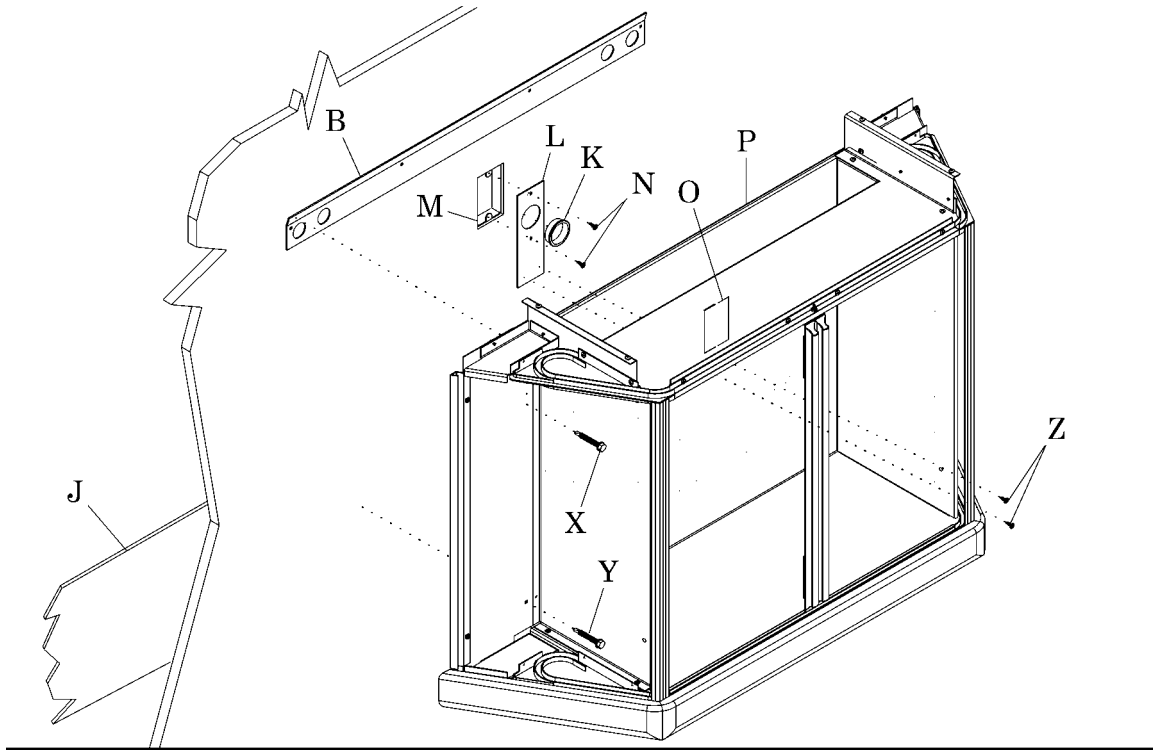

48"  
(122 cm)

i803\_003

**Figure 4. Headwall Assembly Dimensions**

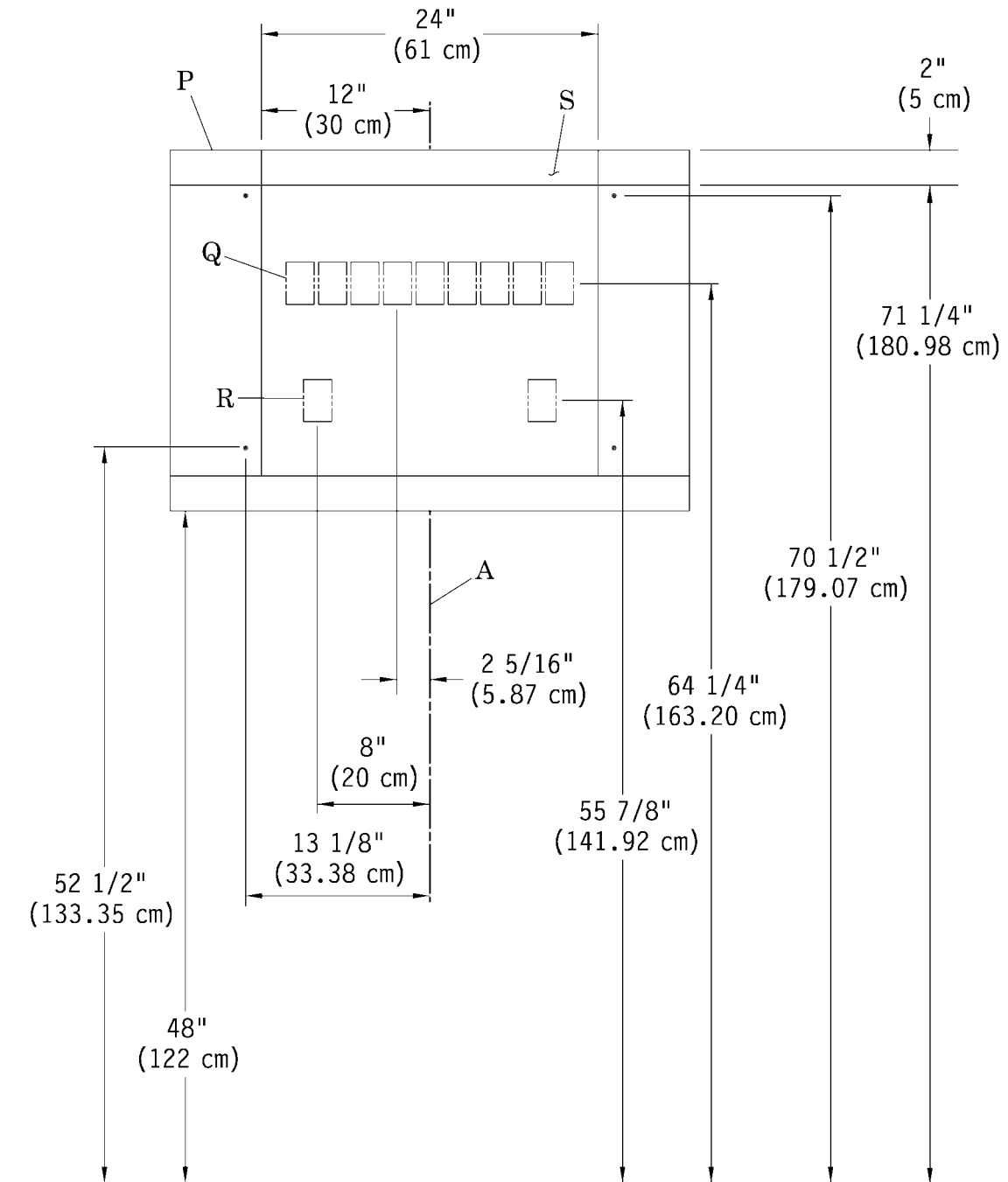

i803\_004

14. Refer to the as-built drawings for the specific location of the medical gas stubs, and have the **medical gas contractor** make the connections to the building's medical gas service drops in accordance with all applicable state and local codes, and the following:
  - The latest edition of the National Fire Protection Association (NFPA) 99
  - Canadian Standards Association (CSA) Z305.1, *Non-Flammable Medical Gas Piping Systems*
  - CSA Z318.6, *Commissioning of Medical Gas Systems in Health Care Facilities*
15. Have the **electrical contractor** make the connections to the electrical and communication services in accordance with all applicable state and local codes, and the following:
  - NFPA 70, *National Electrical Code*®<sup>1</sup> (NEC®<sup>2</sup>)
  - CSA C22.1, *Canadian Electrical Code—Safety Standard for Electrical Installations*
  - CSA Z318.5, *Commissioning of Electrical Gas Equipment and Standards in Health Care Facilities*
  - CSA Z318.7, *Commissioning of Communication Systems in Health Care Facilities*
16. Install the electrical devices and faceplates on the outlet boxes (Q) and (R) (see figure 4 on page 7).
17. Install the tambour side panels (U) and front corner trim (V) (see figure 3 on page 6).
18. Install the four screws to secure the top panel (T) to the headwall assembly (P).

---

1. National Electrical Code® is a registered trademark of National Fire Protection Association, Inc.

2. NEC® is a registered trademark of National Fire Protection Association, Inc.